

REGIONAL OFFICE, HAPUR

OPTION - 04

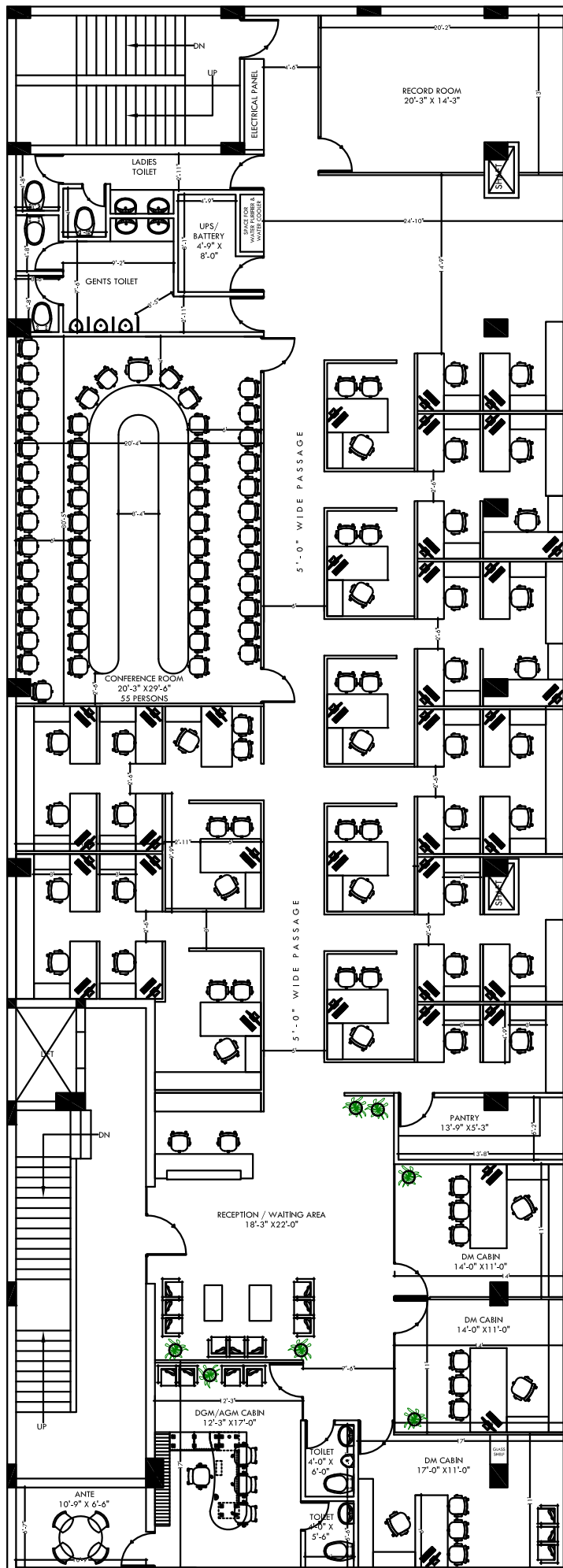

GENERAL NOTES:-

THIS DRAWING IS THE PROPERTY OF ARCH DESIGN ARCHITECTS AND IS NOT TO BE USED FOR ANY PURPOSE OTHER THAN FOR WHICH IT IS ISSUED WITH OUT PERMISSION OF ITS PRINCIPALS.

THIS DRAWING IS TO BE READ IN CONJUNCTION WITH OTHER RELEVANT ARCHITECTURAL, STRUCTURAL AND OTHER SERVICES / CONSULTANTS DRAWING. IT SHALL BE THE DEEMED RESPONSIBILITY OF THE CONTRACTOR/ FABRICATOR TO BRING IN TO NOTICE OF ARCHITECTS IF ANY DISCREPANCY WITHIN OR BETWEEN THE DRAWINGS PRIOR TO CONSTRUCTION.

ALL WRITTEN DIMENSIONS ARE TO BE FOLLOWED AND THE DRAWING IS NOT TO BE SCALED.

NOTE:- ALL DIMENSION ARE IN FEET UNTIL MENTION IN DWG

PROJECT:-

PROPOSED INTERIOR LAYOUT PLAN
FOR CANARA BANK,
HAPUR REGIONAL OFFICE
DELHI ROAD, HAPUR

DRAWING TITLE:-

INTERIOR LAYOUT PLAN
FOR SECOND FLOOR

SCALE:-

N.T.S.

DWG. NO.:-

CB-ROH-01

DATE:-

24.06.2021

NORTH:-



**ARCH DESIGN
ARCHITECTS**

ARCHITECTS, INTERIOR DESIGNER, PROJECT MANAGEMENT
H.O. :- C-32, MASAROVER PARK, NEW DELHI-32 B.O. :- GANPATI NIWAS,
CIVIL LINES, BULANDSHAHR-203001 MOB: 9899227440, 9412857600,
Email :- archdes12@gmail.com